

SONIC

ULTRA-Lightweight Travel Trailers



SONIC
ULTRA-Lightweight Travel Trailers



❄ Your Venture Starts Here. ❄



The optional Murphy Bed has sofa cleverly hidden under the bed.
(Available in the 190, 200 and 220's)



The bedroom has a padded designer headboard
with reversible quilted comforter.



ULTRA-Lightweight Travel Trailers

SONIC



Resort Décor



Haven Décor

Why limit your comfort because of your tow vehicle? We'd rather enhance your adventure in a Sonic luxury ultra-lightweight travel trailer that can be towed by minivans and SUV's. Designed to be lightweight, but not basic. These luxury items include custom Café Latte mosaic backsplash, Chef Glass cooktop cover and Designer Carefree wood plank linoleum.





Our Safe 'Tek Box keeps your mobile devices off the counter while charging.



The Chef Glass cooktop cover adds additional prep area in the kitchen.

Model SN190VRB

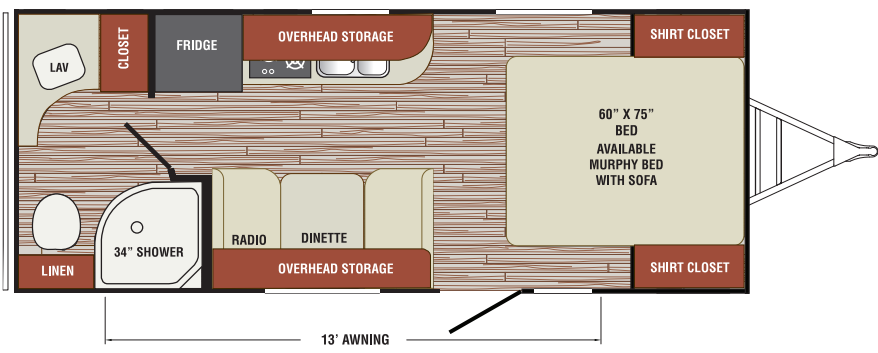

The bathroom features a shower with residential radius glass doors. A linen cabinet and closet offer plenty of storage.



The Large U-shaped dinette easily converts into a 48" x 84" sleeping area.



FLIP SIDE REVERSIBLE FABRIC PACKAGE



The Sonic's Comfort By Design furniture has the flipside reversible fabric.

ULTRA-Lightweight Travel Trailers

SONIC



Model SN220VRB

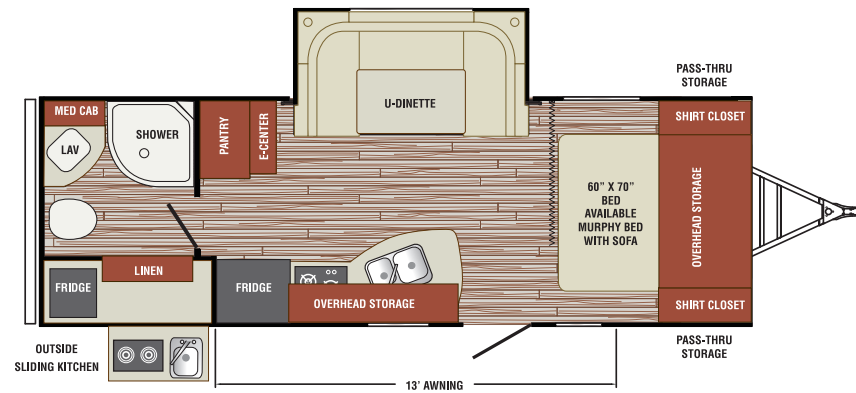

SONIC

Structural Benefits



1. One-piece fiberglass roof from front profile to rear bumper
2. Construction board
3. R-14 residential fiberglass insulation
4. Aluminum roof rafters
5. Aerodynamic front profile 2" x 3" wood
6. Diamond plate rock guard
7. 5 sided Champagne infused fiberglass
8. Easy view LP tank cover
9. (2)- 20lb. LP tanks (Easy to exchange)
10. Norco BAL huck bolted frame
11. Secure Stance angle stabilizer jacks
12. Double entry step
13. Blue LED stairwell safety light
14. Plywood floor decking
15. R-14 residential fiberglass insulation
16. Designer carefree Congoleum® with 3 Year Warranty
17. Darco moisture barrier
18. Tandem axles with self adjusting brakes
19. Aluminum rims (optional)
20. 14" Radial tires
21. Power awning with LED lighting (manual awning standard)
22. Square bumper (sewer hose storage)
23. (2) Exterior marine grade speakers
24. 110V/ outlet and TV hookups
25. Tinted safety glass windows
26. Dexter radius entry door
27. Motorhome grab handle with light
28. Slam latch baggage doors

Huck bolt chassis construction for superior strength.

SONIC

Sonic Floor Plans

SN170VRD

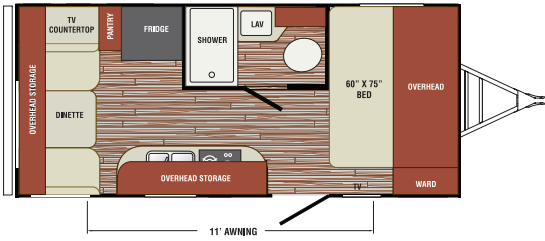

SN170VBH

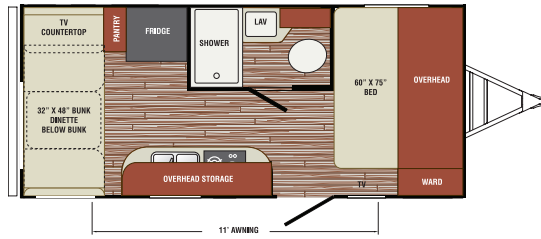

SN190VRB

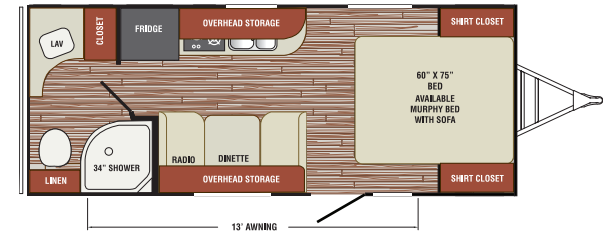

More Features – Less Weight!!

Small but not basic, the Sonic adds value to the ultra-lightweight market at an aggressive price.

SN220VBH

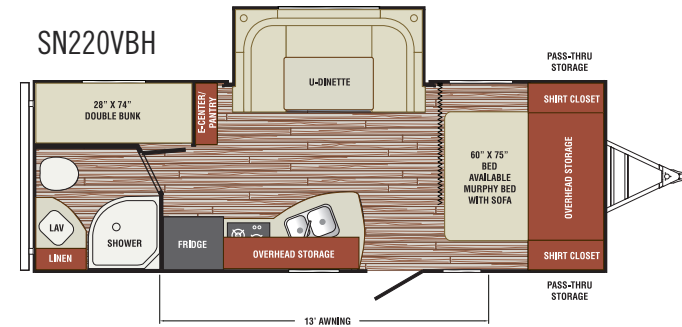

SN230VRL

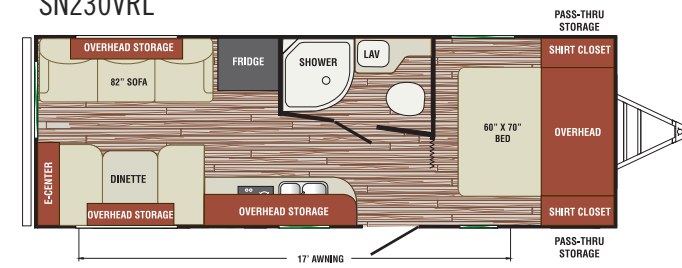

Specifications:	SN170VRD	SN170VBH	SN190VRB	SN200VML	SN220VBH	SN220VRB	SN230VRL	SN234VBH
UVW*	3260	3320	3530	3760	4200	4380	3967	4220
Hitch Weight	340	350	330	310	390	420	524	610
Axle Weight	2920	2970	3200	3450	3810	3960	3443	3610
Carrying Capacity	740	680	970	1040	1000	1440	1233	980
GVWR	4000	4000	4500	4800	5200	5400	5200	5200
Interior Height	6' 10"	6' 10"	6' 10"	6' 10"	6' 10"	6' 10"	6' 10"	6' 10"
Exterior Height	10' 3"	10' 3"	10' 3"	10' 3"	10' 3"	10' 3"	10' 3"	10' 3"
Exterior Width	7' 6"	7' 6"	7' 6"	7' 6"	7' 6"	7' 6"	7' 6"	7' 6"
Exterior Length	21'	21'	22' 10"	23' 4"	26' 5"	26' 11"	26' 9"	26' 5"
Fresh Water (gal.)	40	40	39	39	39	39	39	39
Black Water (gal.)	30	30	30	30	30	30	30	30
Gray Water (gal.)	30	30	30	30	30	30	30	30
Furnace BTUs (1000)	20	20	20	20	20	20	20	20
Tire Size	14" Radial	14" Radial	14" Radial	14" Radial	14" Radial	14" Radial	14" Radial	14" Radial
Awning Length	11'	11'	13'	14'	13'	13'	17'	14'

*This weight reflects the base weight for each model. Your trailer weight will vary according to optional equipment.

Seamless Roofing

ULTRA-Lightweight Travel Trailers

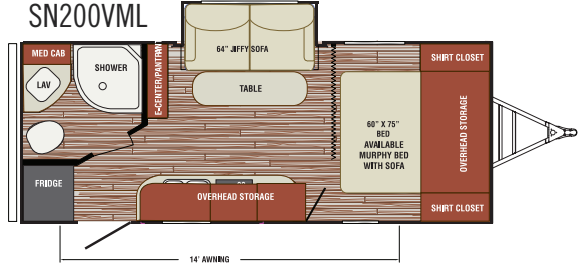

Slam latch storage doors (Available)

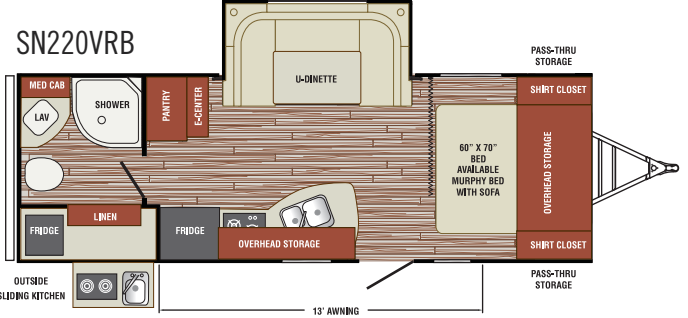

Grab handle with light (Available)

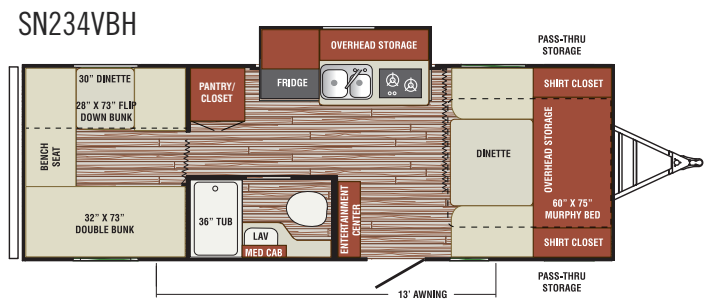

Lighted stairwell



- One piece seamless Fiberglass Roof Construction



- Seamless roof prevents potential leaks
- Water run off from front to back
- Avoid leaks around sidewall seams, windows, doors, compartments and corner seams
- Reliable construction for long term investment

SONIC

Sonic Standards & Options

Bedroom

- Innerspring Mattress
- Valances
- Pleated Night Shades
- Designer Padded Headboard
- Quilted Reversible Comforter
- Overhead Storage
- Under the Bed Storage
- LED Lights

Living Room/Kitchen

- Roller Ball Bearing Drawer Guides
- Safe "T"ek Box
- Double Bowl Sink /sink cover
- 6.3 Cubic Ft. Double Door Refrigerator/Freezer
- 2-Burner Cooktop
- DVD/CD/Stereo/MP3/BlueTooth
- LED Lights
- 6 Gallon gas/electric DSI Water Heater
- Flipside Cushions
- Café Latte Mosaic Backsplash
- Mortise & Tenon Cognac Maple Hardwood Cabinet Doors
- (2) Interior Speakers
- 82" Interior Height
- Skylight
- Designer Carefree Linoleum with 3 Year Warranty

Bathroom

- Residential Radius Shower with Glass Doors
- LED Lights
- Foot Flush Toilet
- Medicine Cabinet
- Power Vent

Exterior/Construction Features

- Diamond Plate Rock Guard
- EZ Exchange (2) 20# LP Tanks w/Auto Change Over
- Large Pass-thru Baggage Doors
- Wide Trek Axles
- Lighted Double Safety Step
- Norco BAL Huck Bolted Frame (E-coated & Epoxy Painted)
- Champagne Color Infused Fiberglass (Walls and Roof)
- Exterior Shower
- Tinted Safety Glass Windows
- LED Lighting
- Laminated Side walls with Aluminum Framing
- (2) Marine Grade Exterior Speakers
- Gutter with Down Spout
- Bumper with Sewer Hose Storage
- Satellite and Cable Hookup
- Porch Light
- Water Heater Bypass Valve
- Marine Style Detachable Power Cord
- Tank Monitor System
- Self Adjusting Brakes

Highway Package (option)

- Black Tank Flush
- Spare Tire, Carrier and Cover
- LP Bottle Tank Cover

Options

- (4) Secure Stance Angle Jacks
- 15,000 A/C
- Hide-a-Bed
- Sofa with Memory Foam Mattress (190, 200, 220)
- Motorhome Grab Handle with Light
- Prewire Zamp Solar
- Sleep Tight Gel Infused Memory Foam Mattress
- Aussie Outside Grill
- Multidirectional LED Lighted Power Awning
- LED TV with Swing Arm Bracket (24"-190 / 28" other models)
- High Polished Aluminum Rims
- Convection Microwave
- Microwave
- 13,500 A/C
- Lighted Power Tongue Jack
- **Lightweight Package** – 8,000 BTU A/C, 4 cu. ft. (170's only)



Your local dealer



Due to continual research and advances, manufacturer reserves the right to change specifications, design, price and equipment without notice, and assumes no responsibility for any error in this literature. Some items shown are not included as standard or optional equipment.



A Division of KZ RV

0985N 900W
Shipshewana, IN 46565
888.988.8440



► www.Venture-RV.com