

SONIC
LITE
BY VENTURE RV

SONIC
BY VENTURE RV

Ultra-Lite Travel Trailers (with weights starting under 2,500 pounds!)



SONIC

BY VENTURE RV

Venture's line of Sonic ultra-lightweight, tandem-axle travel trailers is designed for today's smaller tow vehicles and families on the go. Lightweight Sonics don't sacrifice the amenities your family enjoys and include many motorhome features, like a one-piece seamless fiberglass roof system, slam latch baggage door with magnetic catch, convection microwave (optional), glass cooktop cover and lighted entry grab handle.

SN220VRB ▼ Black Diamond décor



(Below) The 220VBH features a ginormous U-shaped dinette that converts into additional sleeping space.



SN220VBH ▼ Black Diamond décor



SN220VRB ▼ Black Diamond décor



SN220VBH ▲ Black Diamond décor

Sonic baths include a porcelain foot-flush toilet, medicine cabinet, and (on most models) a residential radius shower with glass doors.



The convertible Murphy bed expands the living area on smaller units (where applicable).



All Sonics feature a square bumper for sewer hose storage, and which can receive an optional bumper-mount grill.

SN220VRB ▼ Black Diamond décor

SL149VML

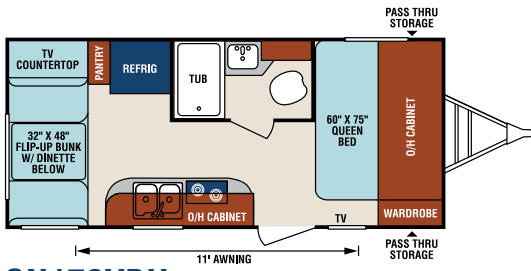

SN170VBH

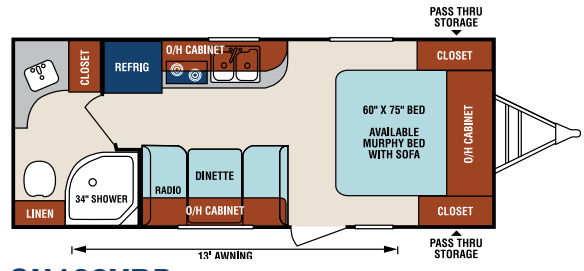

SN190VRB

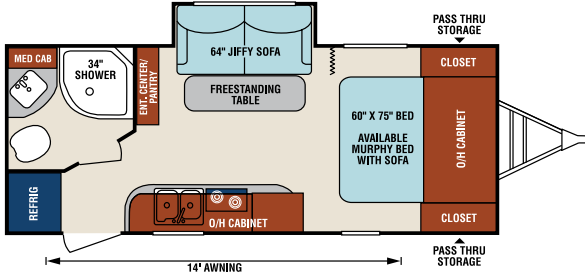

SN200VML

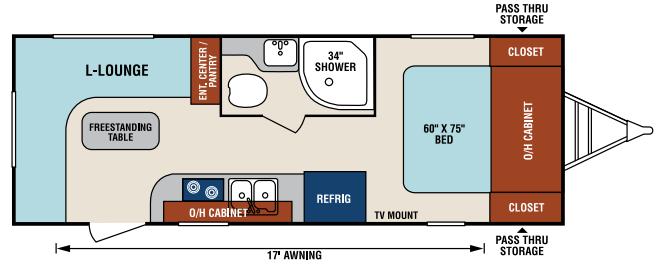

SN210VRD

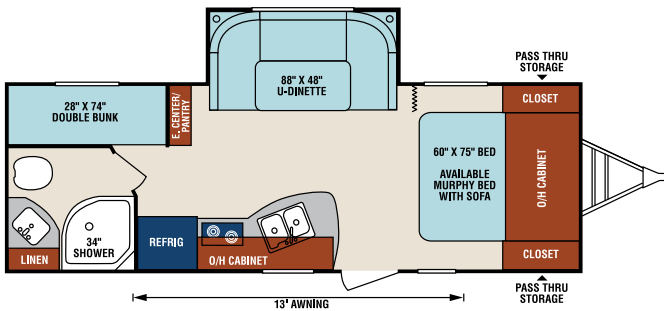

SN220VBH

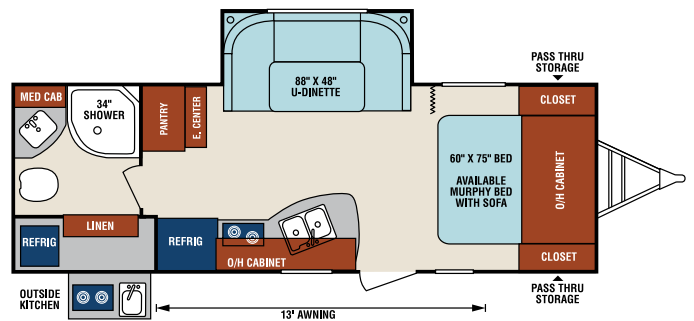

SN220VRB

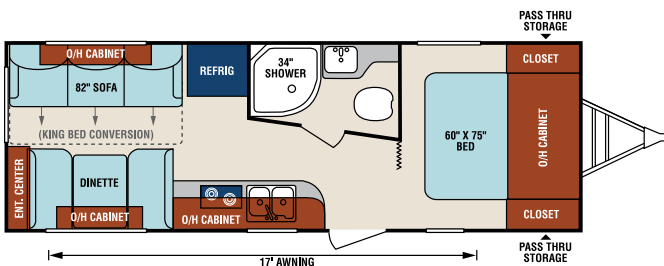

SN230VRL

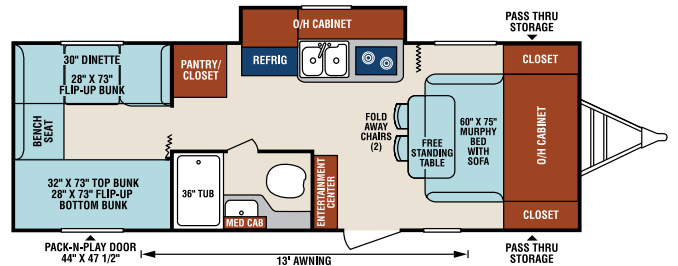

SN234VBH

Travel Trailers	SN170VBH	SN190VRB	SN200VML	SN210VRD	SN220VBH	SN220VRB	SN230VRL	SN234VBH
UVW (Unloaded Vehicle Weight)*	3,320	3,530	3,950	3,935	4,200	4,460	3,967	4,220
Dry Hitch Weight*	350	330	310	430	390	420	524	610
Dry Axle Weight*	2,970	3,200	3,450	3,505	3,810	3,960	3,443	3,610
NCC (Net Carrying Capacity)	680	970	1,040	1,265	1,000	1,440	1,233	980
GVWR	4,000	4,500	5,200	5,200	5,200	5,200	5,200	5,200
Interior Height	82"	82"	82"	82"	82"	82"	82"	82"
Exterior Height with A/C	10' 3"	10' 3"	10' 3"	10' 3"	10' 3"	10' 3"	10' 3"	10' 3"
Exterior Width	90"	90"	90"	90"	90"	90"	90"	90"
Exterior Length	21' 2"	22' 10"	23' 4"	25' 5"	26' 5"	26' 11"	26' 9"	26' 5"
Refrigerator (Cubic Feet)	6.3	6.3	6.3	6.3	6.3	6.3	6.3	6.3
Water Heater Cap. (Gal. G/E w/DSI)	6	6	6	6	6	6	6	6
Fresh Water Capacity (Gallon)	38	38	38	38	38	38	38	38
Black Water Capacity (Gallon)	30	30	30	30	30	30	30	30
Gray Water Capacity (Gallon)	24	30	30	30	30	30	30	30
LP Gas Capacity (Lbs.)	40	40	40	40	40	40	40	40
Furnace BTUs (1,000s)	20	20	20	20	20	20	20	20
Tire Size	14"	14"	14"	14"	14"	14"	14"	14"
Awning	11'	13'	14'	17'	13'	13'	17'	13'

*This weight reflects the rolling average unit weight for each model. Your trailer weight will vary according to optional equipment.



Sonic Construction

1. One-piece seamless fiberglass roof from front profile to rear bumper
2. Construction board
3. R-14 residential fiberglass insulation
4. Aluminum roof rafters
5. Aerodynamic front profile 2" x 3" wood
6. Diamond plate rock guard
7. 5 sided Ivory infused fiberglass
8. Easy view LP tank cover
9. (2)-20lb. LP tanks (Easy to exchange)
10. Norco BAL Huck bolted frame
11. Secure Stance angle stabilizer jacks (Sonic only)
12. Double entry step
13. Blue LED stairwell safety light
14. 5/8" tongue & groove plywood floor decking
15. R-14 residential fiberglass insulation
16. Designer carefree Congoleum® vinyl flooring w/ 3-year warranty
17. Darco moisture barrier
18. Tandem axles with self adjusting brakes
19. Aluminum rims (optional)
20. 14" Radial tires
21. Power awning with LED lighting (manual awning standard)
22. Square bumper (sewer hose storage)
23. (2) Exterior marine grade speakers
24. 110V/ outlet and TV hookups
25. Tinted safety glass windows
26. Radius entry door w/screen door
27. Motorhome grab handle with light
28. Slam latch baggage doors w/magnetic catches
29. Prep for backup camera
30. Prep for solar



Even the smallest Lites feature expansive amounts of storage. The 149VML offers a well thought out rear kitchen, center bath with shower, free-standing folding table with folding chairs and an 80" x 74" bed.

The 149VML offers a ton of storage and countertop work surface for a small camper.

Sonic Lite boasts the same construction techniques, one-piece seamless fiberglass roof and 82-inch interior headroom as its older brother, but is offered with a single axle frame and weights starting at 2,480 pounds. Sonic Lite is light on weight, large on livability, and extremely versatile.



SONIC
LITE BY VENTURE RV

The 149VML comes with a clever folding table and two folding chairs for additional and versatile space.



Black Diamond



Brownstone

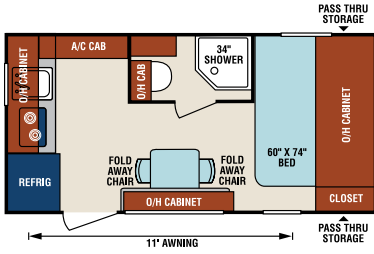
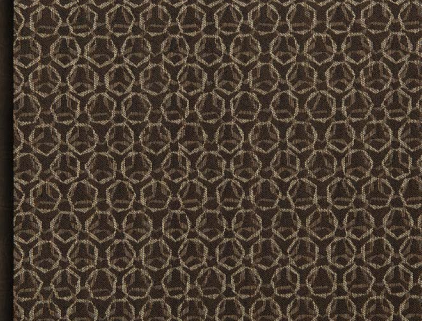

SL149VML **NEW**

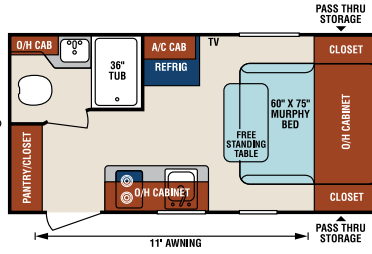

SL150VRK

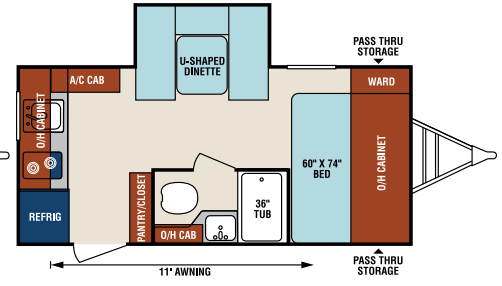

SL167VMS

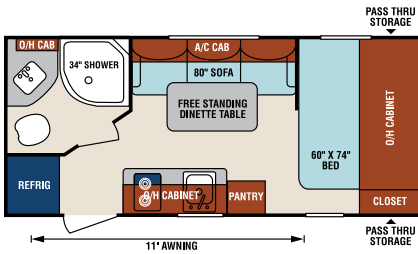

SL168VRB **NEW**

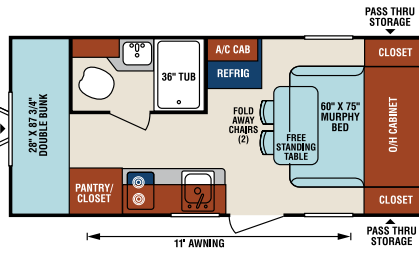

SL169VBH

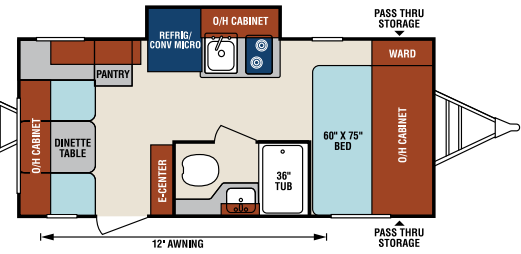

SL169VRD **NEW**



Sonic and Sonic Lite both offer one-piece seamless fiberglass roof construction.

Seamless roofing prevents potential leaks, as the water runs off the front and back with no extrusions or seams. Avoids leaks around the sidewall seams, windows, doors, compartments and corner seams. Reliable seamless construction equals long-term investment.



Travel Trailers	SL149VML	SL150VRK	SL167VMS	SL168VRB	SL169VBH	SL169VRD
UVW (Unloaded Vehicle Weight)*	2,745	2,480	2,898	2,950	2,990	3,376
Dry Hitch Weight*	290	270	350	300	410	332
Dry Axle Weight*	2,455	2,210	2,548	2,650	2,570	TBD
NCC (Net Carrying Capacity)	755	1,020	1,102	1,050	1,010	624
GVWR	3,500	3,500	4,000	4,000	4,000	4,000
Interior Height	82"	82"	82"	82"	82"	TBD
Exterior Height with A/C	9' 5"	9' 5"	9' 5"	9' 5"	9' 5"	TBD
Exterior Width	90"	90"	90"	90"	90"	TBD
Exterior Length	19' 2"	19' 2"	20' 4"	21'	21' 4"	TBD
Refrigerator (Cubic Feet)	4.2	4.2	4.2	4.2	4.2	TBD
Water Heater Capacity (Gal. G/E w/DSI)	6	6	6	6	6	TBD
Fresh Water Capacity (Gallon)	38	38	38	38	38	TBD
Black Water Capacity (Gallon)	30	30	30	30	30	TBD
Gray Water Capacity (Gallon)	30	30	30	30	30	TBD
LP Gas Capacity (Lbs.)	20	20	20	20	20	TBD
Furnace BTUs (1,000s)	16	16	16	16	16	TBD
Tire Size	14"	14"	15"	15"	15"	15"
Awning	11'	11'	11'	11'	11'	12'

*This weight reflects the rolling average unit weight for each model. Your trailer weight will vary according to optional equipment.

Sonic Standards & Options

Living Room/Kitchen

- Seamless Counter Top w/Sink Cover
- Roller Ball Bearing Drawer Guides
- Safe-Tek® Box w/USB Charger
- Double Bowl Sink
- Bluetooth DVD/CD/MP3/AM/FM Stereo w/Remote
- High Efficiency LED Lights
- Flipside Reversible Dinette Cushions
- Mocha Latte Mosaic Backsplash
- Cognac Maple Full Glazed Cabinets
- (2) Interior Speakers
- 82" Interior Height
- Skylight
- Designer Carefree® Linoleum w/3-Year Warranty

Appliances

- 6.3 CU FT Double Door Refrigerator/Freezer
- 6-GAL DSI Quick Recovery Water Heater
- 2-Burner Cooktop w/Glass Cover
- Vented Range Hood w/Light

Bath

- Residential Radius Shower w/Glass Doors (most models)
- High Efficiency LED Lights
- Porcelain Foot-Flush Toilet
- Medicine Cabinet
- Power Vent

Bedroom

- Memory Foam Mattress
- Designer Valances
- Pleated Nightshades
- Lighted Designer Padded Headboard w/Storage
- Quilted Reversible Comforter
- Overhead Storage
- Under-Bed Storage
- High Efficiency LED Lights
- USB Charging Port
- Two Shirt Closets (most Models)

Exterior/Construction

Features

- One Piece Seamless Fiberglass Roof
- Enclosed Heated Fresh Water Tank
- Diamond Plate Rock Guard

- EZ Exchange® (2) 20 LB Tanks w/ Auto Changeover
- Large Pass-Thru Storage
- Slam Latch Baggage Doors w/ Magnetic Catches
- Wide-Trek® Axles
- Lighted Double Safety Step
- Norco BAL® E-Coated & Epoxy-Painted Huck Bolted Frame
- Motorhome-Style Grab Handle w/Light
- Ivory Infused Fiberglass Walls & Roof
- Exterior Shower w/Hot & Cold Water
- Tinted Safety Glass Windows
- High Efficiency Exterior LED Lighting
- Laminated Sidewalls w/Aluminum Framing
- (2) Marine Grade Exterior Speakers
- Bumper w/Sewer Hose Storage
- Satellite & Cable Hookup
- Porch Light
- Water Heater Bypass Valve
- Marine-Style Detachable Power Cord w/Light

- Tank Monitor System (4) Secure Stance® Angled Stabilizer Jacks
- Prewire for Solar
- Prewire for Backup Camera

Options

- 15,000 BTU A/C
- 13,500 BTU A/C
- Murphy Bed Sofa w/Memory Foam Mattress (most models)
- A-Frame Bike Rack
- Sleep Tight® Gel-Infused Memory Foam Mattress
- Swing Away Bumper Mount Grill
- Multi-Directional LED Lighted Power Awning
- LED TV w/Swing Arm Bracket
- High-Polished Aluminum Rims
- Convection Microwave
- Microwave
- Lighted Power Tongue Jack

Highway Package

- Black Tank Flush
- Spare Tire, Carrier & Cover
- LP Bottle Cover

Sonic Lite Standards & Options

Living Room/Kitchen

- Seamless Counter Top w/Sink Cover
- Roller Ball Bearing Drawer Guides
- Hand Glazed Cabinet Doors
- Safe™ EK Box w/USB Charger
- High Efficiency LED Lighting
- Flip Side Reversible Dinette Booth Cushions
- Mocha Latte Mosaic Backsplash
- (2) Interior Speakers
- 82" Interior Height
- Skylight
- Designer Carefree Linoleum w/3 Year Warranty
- Pleated Nightshades
- Shoe Cubby
- Lux Maple Mortise and Tenon Hardwood Doors

Bathroom

- High Efficiency LED Lighting
- Porcelain Foot Flush Toilet
- Lux Maple Mirrored Medicine Cabinet w/Storage (VBF)
- Power Vent
- Skylight Shower /Tub Surround
- Designer Shower Curtain

Bedroom

- High Efficiency LED Lighting
- Memory Foam Mattress
- Designer Valances
- Pleated Nightshades
- Lighted Designer Padded Headboard w/Storage
- Quilted Reversible Comforter
- Over Head Storage
- Shirt Closet(s)
- USB Charger

Exterior/Construction Standards

- High Efficiency LED Lighting
- One Piece Seamless Fiberglass Roof
- Easy exchange 20# LP Tank
- Large Pass-Thru Storage
- Lighted Safety Step
- Norco-BAL E-Coated & Epoxy Painted Huck Bolted Frame
- Five Sided Ivory Color Infused Fiberglass
- Tinted Safety Glass Windows
- Aluminum Framed Floor, Sidewalls and Roof
- (2) Marine Grade Speakers
- Large Bumper with Sewer Hose Storage

- Satellite and Cable Hookup
- Double Entry Step
- Porch Light
- Water Heater By-Pass Valve
- Tank Monitor System
- Marine Style 30 Amp Power Cord with light
- 6 Gallon DSI Gas/Electric Water Heater

Exterior Luxury (Mandatory Option)

- High Polished Aluminum Rims
- (4) BAL Scissor Jacks w/Foot Pads
- Motorhome Lighted Grab Handle
- Black Tank Flush
- Prewire for Solar
- Prewire for Backup Camera
- Motorhome Style Slam Latch Baggage Doors
- Multi Directional LED Lighted Power Awning

- Exterior Shower w/Hot & Cold Water

Interior Luxury Package (Mandatory Option)

- Bluetooth DVD/CD/MP3/AM/FM Stereo w/Remote
- 4.2 Refrigerator
- 2-Burner Cooktop
- Convection Microwave
- Vented Range Hood
- Residential 8,000 BTU A/C

Options

- LED TV w/Swing Arm Bracket
- Low Profile 13.5 AC
- Lighted Power Tongue Jack
- Spare Tire, Carrier & Cover
- Swing Away Bumper Mount Grill
- A-Frame Bike Rack

Dealer:



985 N 900 W • Shipshewana, IN 46565
www.venture-rv.com

Due to continual research and advances, manufacturer reserves the right to change specifications, design, price and equipment without notice, and assumes no responsibility for any error in this literature. Some items shown are not included as standard or optional equipment. ©2016 Venture | 11/18/16 | 50M