



SONIC X

Travel Trailers

The Ultimate RV!



Designed for campers, by campers.

SONIC X

Venture RV's Sonic X is like nothing you've ever experienced before, offering off-road, off-grid, off-the-charts adventure! It's the perfect city escape for the ultimate traveler, and is loaded with technology with modern appeal.

Sonic X interiors include solid wood cabinets with roller ball bearing drawer guides, a large undermount stainless steel single bowl sink and two interior speakers.



In the bed area, Sonic X offers a Murphy bed with foam mattress upgrade, StorMore nightstands with 110V and USB port, under-bed storage and two shirt closets.

TRAVEL TRAILERS	SN211VDBX	SN220VRBX
UVW (Unloaded Vehicle Weight)*	5,470	5,610
Dry Hitch Weight*	700	570
Dry Axle Weight*	4,770	5,040
CCC (Cargo Carrying Capacity)	1,805	1,675
Interior Height	82"	82"
Exterior Height with A/C	10' 4"	10' 4"
Exterior Width	90"	90"
Exterior Length**	27' 6"	27' 6"
Refrigerator (Cubic Feet)	7	7
Water Heater Capacity (Gal. G/E w/DSI)	6	6
Fresh Water Capacity (Gallon)	78	78
Black Water Capacity (Gallon)	30	30
Gray Water Capacity (Gallon)	30	30
LP Gas Capacity (Lbs.)	40	40
Furnace BTUs (1,000s)	20	20
Tire Size	15"	15"
Awning	14'	12'

*This weight reflects the rolling average unit weight for each model. Your trailer weight will vary according to optional equipment.
 **Exterior length is measured from rear of bumper to leading edge of coupler.

SN211VDBX

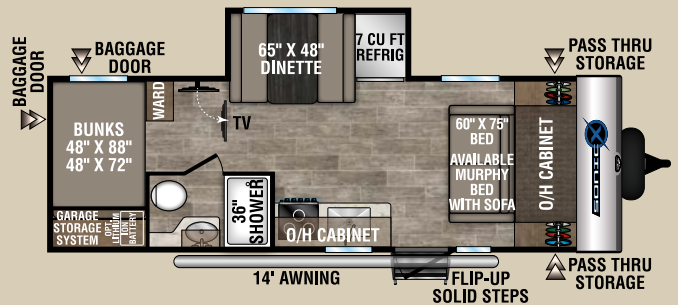

SN220VRBX





treme FEATURES

Solar Package



Camp anywhere at any time using energy-efficient and clean solar power. The GO Power Solar Package with a lithium ion battery, coupled with a low-consumption power air conditioner, allows for up to five hours of A/C without a recharge!*

- ⊗ (4) 100 Watt Roof-Mounted Solar Panels
- ⊗ (1) 250 Amp Hour Lithium Ion Battery
- ⊗ (1) IC2000 Watt Inverter w/Charger
- ⊗ 11.5 BTU Low Profile / Low-Consumption Power A/C
- ⊗ High Definition Interior / Exterior LED Lighting

Off Road Package



Need to get away from it all? The Sonic X ultra-lite travel trailer is the RV for you. Explore the backcountry in confidence with our tough Off-Road Package!

- ⊗ 360-Degree Welded Tubular Brush Guard
- ⊗ (2) Roof-Mounted High Definition LED Light Bars
- ⊗ Triple Stack Round Welded Bumper
- ⊗ (4) 15" Off-Road Tires
- ⊗ 15" Under-Mount Spare Tire
- ⊗ (2) 3,500 LB Torsion Axles
- ⊗ (4) High-Rise Power Stabilizer Jacks w/Independent Motors
- ⊗ 7 1/2" BAL Norco NXG Huck-Bolted Frame
- ⊗ (2) 45 GAL Fresh Water Tanks

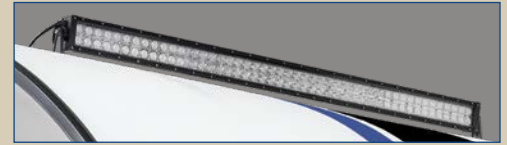

Front & rear LED light bars assist in loading & unloading

Water Filtration System (option)



The Boondocker water filtration system is another Sonic X exclusive! You can now obtain freshwater anywhere, any time. All you need is a nearby lake or river!

- ⊗ (1) Oxygen Ozone Generator
- ⊗ (1) 5 Micron Water Filter
- ⊗ (1) .02 Sub-Micron Filter
- ⊗ Shurflo 4048 12V Pump w/City Bypass Valve

Storage System



Do you enjoy land- or water-based outdoor adventures? Take them with you with Sonic X's Toy Storage System!

- ⊗ Convertible Gear Rack
- ⊗ Hitch-Mounted Bike Rack
- ⊗ Outside Garage Storage System
- ⊗ Concealed Gun/ Fishing Rod Cabinet

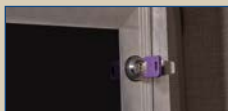

Built-in wall safe



Large hidden storage for fishing poles or hunting rifles



Front-mounted bike rack holds up to two bikes

***contingent on weather conditions**



Sonic X's Weather Shield features a radiant foil barrier, forced heat, and enclosed underbelly.



LevelMate PRO lets you level your unit on the first try!



Packages & Options

Sonic Xtreme Solar Package (Standard)

(4) 100W roof mounted solar panels, (1) 250 amp hour lithium ION battery, IC2000W inverter w/charger, 11.5 low profile, low power consumption A/C, high definition interior/exterior LED lighting.

Sonic Xtreme OFF-ROAD Package (Standard)

360-Degree welded tubular brush guard, (2) roof-mounted high definition LED light bars, triple stack round welded bumper, (4) 15" off-road tires, 15" under-mount spare tire, (2) 3,500 LB torsion axles, (4) high-rise power stabilizer jacks w/independent motors, 7 1/2" BAL Norco NXG Huck-bolted frame, (2) 45 GAL fresh water tanks.

Sonic Xtreme Storage System (Standard)

Convertible gear/bike/cargo rack, hitch-mounted bike rack, outside garage storage system, concealed gun/fishing Rod cabinet.

Weather-Shield Package (Standard)

Forced-air heated & enclosed underbelly, 360° residential fiberglass insulation, 360° radiant foil insulation, radiant foil bubble insulation-wrapped tanks, lithium battery thermostat-controlled heat pad (360° = roof, floor, front/rear walls).

Sonic Xtreme Luxury Package (Standard)

Solid-surface countertops, LED TV w/swing-arm mount, dark- tint windows.

Exterior Package (Standard)

Friction-hinge entry door, battery disconnect switch, steel fender guards, 3- piece fiberglass roof system, 5/8" tongue & groove plywood floor decking, spread axles w/auto-adjust brakes & EZ Lube hubs, NXG Huck-bolt frame, prewired for Furrion backup camera, dedicated cable & satellite hookups, Furrion marine-grade detachable power cord, slam-latch baggage doors w/magnetic catches, motion-activated pass-thru storage light, hot & cold outside shower, Keyed Alike key system, Venture bottle opener/dog tie-out, carbon fiber pattern rock guard & slideout end walls, solid flip-up step, swing-away grab handle, Screen Shot spring screen door, LED lighted power awning, black tank flush, (2) 20 LB LP tanks w/easy-access cover.

Interior Package (Standard)

StorMore bedside nightstands w/110V & USB charging, stainless steel microwave, designer tile backsplash, 7 CU FT double-door refrigerator/freezer, 6 GAL gas/electric DSI water heater, vented range hood, Safe "T"ek Box w/110V & USB charging ports, motion-activated interior entry light, quilted comforter, designer padded headboard, Beauflor residential linoleum w/7-year limited warranty, living area skylight, LED lighting w/individual switches, 82" ceiling height, bathroom power exhaust fan, shoe cubby (VBF), Surf(x) seamless tabletops, porcelain foot-flush toilet, Euro Steel Faucet.

Options

Xtreme water filtration system (ozone generator, 5 micron filter, .02 sub-micron filter, Shurflo 4048 12V pump w/city bypass valve), 12V 8 CU FT refrigerator.



985 N 900 W | Shipshewana, IN 46565 | www.venture-rv.com

Due to continual research and advances, manufacturer reserves the right to change specifications, design, price and equipment without notice, and assumes no responsibility for any error in this literature. Some items shown are not included as standard or optional equipment.
©2020 Venture | 1/25/21 | 10M

