



STRATUS

Ultra-Lite Travel Trailers



Designed for campers, by campers.

STRATUS

Stratus has it all... an eye-catching exterior, stunning decor and a long list of exciting standard features. Not to mention, there's a significant amount of storage, including clever concealed spaces for out-of-sight organization. This affordable ultra-lite travel trailer has got the goods, with a fresh, modern vibe.



Kitchens feature a window to welcome in natural light. The gas range with glass cover adds valuable counter space, and the microwave and oven offer the same conveniences as home.

KEY FEATURES:

- Super lite weight starting at 5,200 pounds
- Modern farmhouse design with heirloom maple and antique white glazed cabinets
- Double door 10 CU FT refrigerator
- 64 gallon grey tank capacity (varies by floorplan)
- Available in four exterior colors

Contrasting light and dark woodwork gives a nod to today's mixed cabinetry aesthetic, with Antique White nicely offsetting the dark Heirloom Maple.



The 60 x 80-inch true residential queen bed offers storage beside, above and below. USB ports, 110V outlet and light switches are all within reach, as is CPAP nightstand storage.



Bathrooms include porcelain foot-flush toilet.



The LED TV and multi-media stereo, DVD and wireless connectivity are perfect for indoor camping, and the optional 30-inch fireplace takes the edge off cool mornings and chilly nights. The discreet cubby below the fireplace stores Rover's doggie dish, or lets you keep shoes at the ready.

STRATUS FLOORPLANS

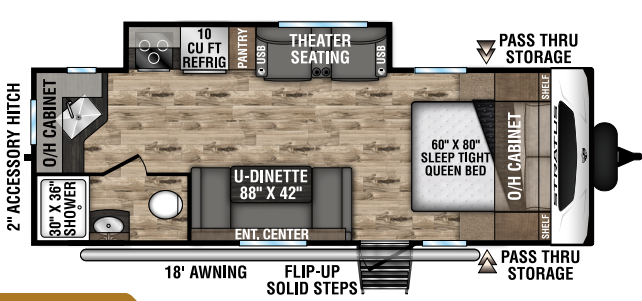

NEW

SR221VRK

UVW – 5,320 | Exterior Length – 27' | Sleeps – 4

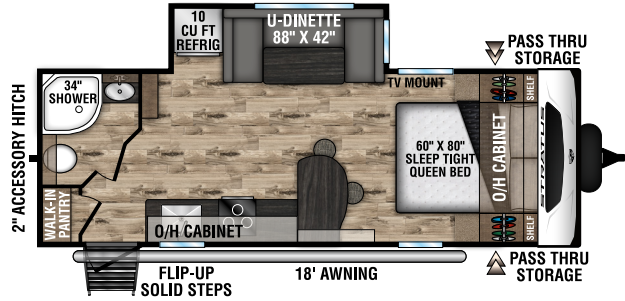

SR231VRB

UVW – 5,210 lbs. | Exterior Length – 26' 6" | Sleeps – 4

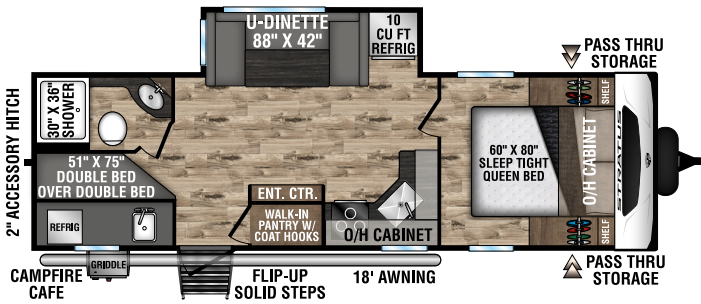

SR261VBH

UVW – 5,800 lbs. | Exterior Length – 30' | Sleeps – 8

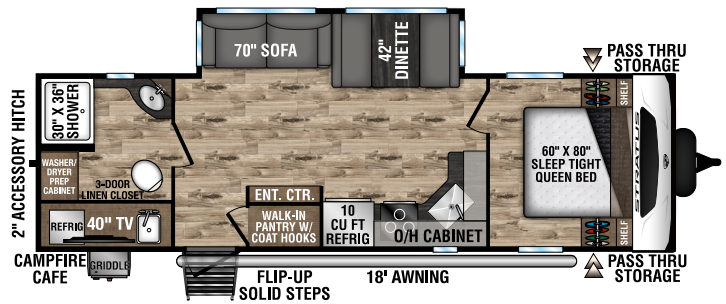

NEW

SR261VRB with washer/dryer prep

UVW – 6,490 lbs. | Exterior Length – 31' 11" | Sleeps – 6

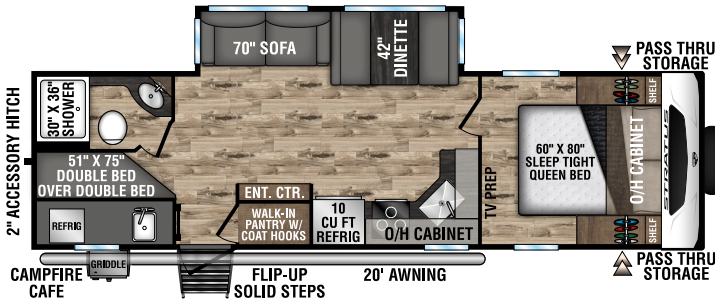

SR281VBH

UVW – 6,410 lbs. | Exterior Length – 31' 10" | Sleeps – 10

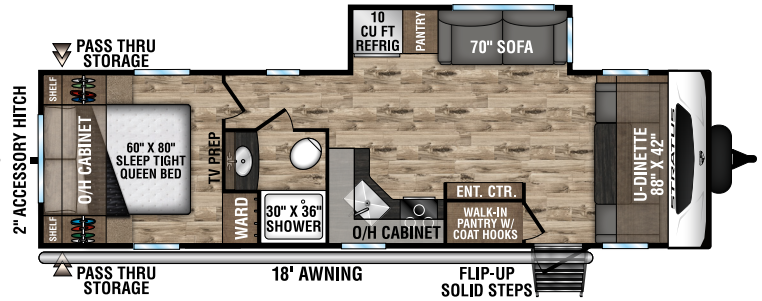

SR281VFD

UVW – 6,370 lbs. | Exterior Length – 32' 3" | Sleeps – 6

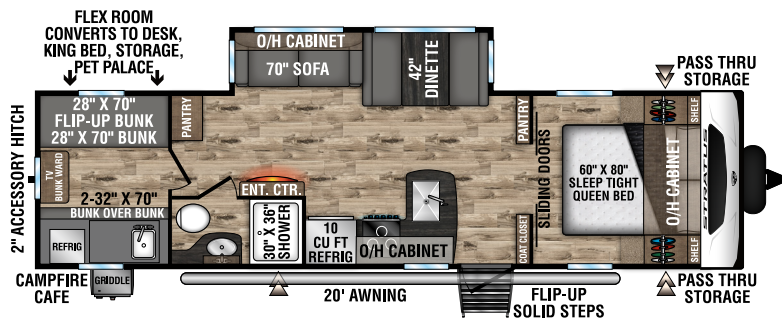

SR291VQB

UVW – 6,830 lbs. | Exterior Length – 33' 11" | Sleeps – 10

FEATURES & SPECIFICATIONS

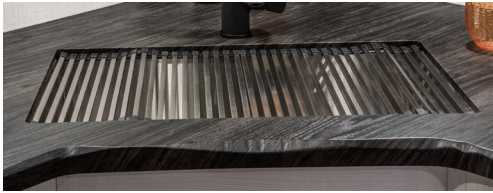

Large single-bowl stainless steel under-mount sink with cover/dish drying racks.



Seamless Surf-X countertops & tabletops with live edge.



Stratus features a glass-topped, flush-mounted, 3-burner cooktop with Furrion oven.



Dune Décor



Let's face it, camping is all about eating. With the generous 10 CU FT refrigerator, you don't need to skimp on anything!



Dinettes offer tufted dinette cushions and two 36" under-seat removable storage bins. Entertainment center features 40" smart TV w/swing-arm.



Antique White & Heirloom Maple-glazed hardwood cabinet doors & drawer faces with full-extension ball bearing drawer guides.



The optional theater seats recline individually, and offer heat, massage, and USB ports.

	SR221VRK	SR231VRB	SR261VBH	SR261VRB	SR281VBH	SR281VFD	SR291VOB
UVW (Unloaded Vehicle Weight)*	5,320	5,210	5,800	6,490	6,410	6,370	6,830
Dry Hitch Weight*	670	570	740	680	650	890	800
Dry Axle Weight*	4,650	4,640	5,060	5,810	5,760	5,480	6,030
CCC (Cargo Carrying Capacity)	2,015	2,075	1,585	1,810	1,890	2,835	2,460
Interior Height	78"	78"	78"	78"	78"	78"	78"
Exterior Height with A/C	10' 10"	10' 10"	10' 10"	10' 11"	10' 10"	10' 10"	10' 10"
Exterior Width	96"	96"	96"	96"	96"	96"	96"
Exterior Length**	27'	26' 6"	30'	31' 11"	31' 10"	32' 3"	33' 11"
Refrigerator (Cubic Feet)	10	10	10	10	10	10	10
Water Heater Cap. (Gal. G/E w/DSI)	6	6	6	6	6	6	6
Fresh Water Capacity (Gallon)	45	45	45	45	45	45	45
Black Water Capacity (Gallon)	34.5	34.5	34.5	34.5	34.5	34.5	34.5
Gray Water Capacity (Gallon)	34.5	34.5	64	64	64	34.5	34.5
LP Gas Capacity (Lbs.)	40	40	40	40	40	40	40
Furnace BTUs (1,000s)	30	30	30	30	30	30	30
Tire Size	15"	15"	15"	15"	15"	15"	15"
Awning	18'	18'	18'	18'	20'	18'	20'

*This weight reflects the rolling average unit weight for each model. Your trailer weight will vary according to optional equipment.

**Exterior length is measured from rear of bumper to leading edge of coupler.

CLOUD 9 PACKAGE 1.4

60" x 80" Serta Foam mattress
Venture LevelMate PRO system
Tucked bumper w/2" accessory hitch
Roof-mounted solar prep
Rear backup lighting
Exterior docking station
King Wi-Fi prep
Entry door w/clear view window
HDMI/DVD stereo w/5.1 AMP USB charger
40" smart TV w/swing-arm
Aerodynamic front radius window
Modern farmhouse-style passage door(s)
Motion light in bathroom
Main control panel
New upgraded residential furniture
RV airflow system w/up to 40% more efficient A/C air flow
Modern farmhouse design w/Antique White & Heirloom Maple glazed cabinets
Large single-bowl stainless steel under-mount sink w/cover/dish drying racks
Live edge countertops
10 CU FT refrigerator
Venture cutting board
Pet defender screen protector
Fiberglass slide-out end walls
Beauflor slideout flooring (no carpet)

WEATHER-SHIELD PACKAGE (MANDATORY)

Forced air heated & enclosed underbelly
Enclosed gate valves
360-degree residential fiberglass insulation
360-degree radiant foil insulation
Radiant foil-wrapped tanks & reflective PVC roof membrane w/lifetime warranty
Azdel Onboard composite panels

EXTERIOR PACKAGE (MANDATORY)

Carbon fiber pattern rock guard
Friction-hinge entry door
Large assist grab handle
Tinted safety glass windows
5/8" tongue & groove plywood floor decking

NXG huck bolt frame
15" radial tires w/EZ Lube hubs
Wide-trek axles w/self-adjusting brakes
(4) angled stabilizer jacks
(2) 20 LB LP tanks w/easy access cover
Rear ladder
Walkable roof
Gutter rails w/downspouts
Gutter rails above slideouts
Hot & cold outside shower
Black tank flush
6 GAL gas/electric DSI water heater
Furrion marine-grade detachable power cord
Prewired for Furrion observation camera
Dedicated cable & satellite connections
Marine-grade exterior speakers
Digital antenna receiver
High-efficiency LED exterior lights
Blue LED stabilizer accent lighting
Motion-activated pass-thru storage light
Magnetic baggage door catches
Keyed Alike key system
Battery disconnect
Lighted power tongue jack
Flip-up aluminum solid step
Spare tire & carrier
15" high polished aluminum rims
Venture RV bottle opener/dog tie down
51 GAL fresh water tank (VBF)
64 GAL gray water tank (VBF)*

INTERIOR PACKAGE (MANDATORY)

Porcelain foot-flush toilet
Full-length closets w/StorMore nightstands
Gas struts under master bed
Shoe storage
Coat rack (varies by floorplan)
Pet dish location
Safe-Tek hidden storage w/charging center w/110V & USB charging ports
High-efficiency LED lighting
Large panoramic windows
Skylight w/shade
Flush floor slideout

*VBF: Varies by Floorplan

Full-extension ball bearing drawer guides
Nightshades
Residential-style valances
Flush-mounted interior speakers
Coleman Whisper A/C
Motion-activated interior entry light
30" wide-view fireplace (N/A 231VRB)
Jiffy w/fold-down center console
Seamless Surf-X countertops & tabletops
No carpet
Hardwood cabinet doors & drawer faces
Extra-large pantry/cabinet storage
High-rise metal faucet w/sprayer
Tufted cushions at dinette
Microwave
Furrion oven & 3-burner cooktop w/flush glass cover

OPTIONS

(3) exterior colors (gray, red, blue) (white is standard)
Off-the-grid solar PKG incl. (1) 100W panel & controller
(4) power stabilizer jacks
LevelMatePRO leveling system*
50 AMP service w/2nd A/C prep
15,000 BTU A/C IPO 13,500 BTU A/C
Low-profile 15,000 BTU A/C IPO 13,500 BTU A/C
2nd A/C (13,500 BTU, 50A required)
Backup observation camera
Theater seating w/heat, massage, & USB ports IPO jackknife sofa
Tri-fold sofa IPO jackknife sofa
40" LED HD smart TV w/swing arm*
8 CU FT gas/electric refrigerator

*Included in the Cloud 9 Package 1.4

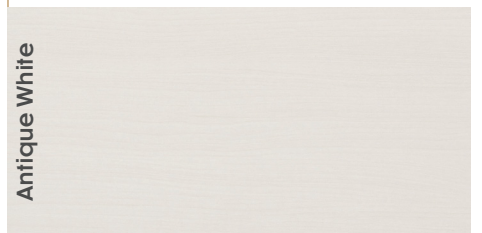

EXTERIOR FEATURES



Stratus comes with a Lamilux premium high-gloss gelcoat surface that's easy to clean and won't rust, rot, corrode or peel. The power awning includes LED lights.

Wheels are high-polished, black-accented aluminum, and radial tires are filled with nitrogen. Secure stabilizer jacks are mounted at 45 degrees for added stability. Pass-through storage compartment with heavy-duty slam-latch doors include motion light and magnetic door catches. Power tongue is lighted for added convenience.



Screen Shot screen door and solid flip-up step keep the bugs out and add secure footing.



Several Stratus floorplans offer the Campfire Café, an outside cooking station that brings the conveniences of indoor cooking outdoors (SR281VBH shown).



Exterior docking station includes outdoor shower.



STRATUS
CONSTRUCTION



Arctic White (Standard)



Victory Red



Indigo Blue



Aztec Gray



LevelMate PRO lets you level your unit on the first try! This option calculates and displays the height required to achieve a perfectly level position.



Stratus' Weather Shield features a radiant foil barrier, forced heat, enclosed underbelly, enclosed gate valves and reflective PVC roof membrane with limited lifetime warranty.



985 N 900 W | Shipshewana, IN 46565 | www.venture-rv.com

Due to continual research and advances, manufacturer reserves the right to change specifications, design, price, and equipment without notice, and assumes no responsibility for any error in this literature.

Some items shown are not included as standard or optional equipment.

©2023 Venture | 00/00/23 | 00M